

Name: Reno Savoya  
 City: Lyon State: France

Date: 06/04/2019 Event: French Nats Rd2  
 Track: RACG Grenoble (wet)



Track  Dirt  Carpet  Tight  Smooth  Hard Packed  Dry Grip Level:  Low  Medium  High  
 Conditions:  Clay  Astro Turf  Open  Rough  Loamy  Wet Tread Level:  Pin  Ghost Pin  Slicks

**Front Suspension**

Toe: 1° out Camber: -1°  
 Ride Height: 20 mm Caster Block:  0°  5°  
 Kick Shim(s):  2mm  1mm  Wedge(20°)  Other:  
 VLA Setting:  Short Arm  Long Arm  
 Front Pivot:  Alum  Composite  Brass   
 Pivot Height:  SLRC  LRC  MRC  HRC  
 Piston: 2x1.7mm Oil: 37.5 wt  
 Limiters: Internal: 2mm External: 0 Stroke: 22 mm  
 Shock Eyelet:  Std.  +2 Shock Location: 2 - middle  
 Spring: LF Sky Blue TLR223052 Sway Bar: none  
 Spindle Steering Arm:  4  5  6   
 Spindle Ball Stud:  Standard  Low Spacers:  
 Draglink Ball Stud:  Standard  Low Spacers:  
 Axle Spacing:  0  +.5mm  +1mm  
 Trail:  2mm  3mm  4mm  
 Camber Link, Inner:  1  2  3 Outer:  A  B  
 Tower:  Stiffezel  Carbon  Carbon +2mm   
 Mud Guard:  Soft  Standard  Stiffezel  
 Front Wheels:  Standard  Stiffezel  
 Front Wing:  Low  High Narrow  High Wide

**Stiffezel Parts:**

Front Arm  Rear Arm  
 Chassis Brace/Waterfall

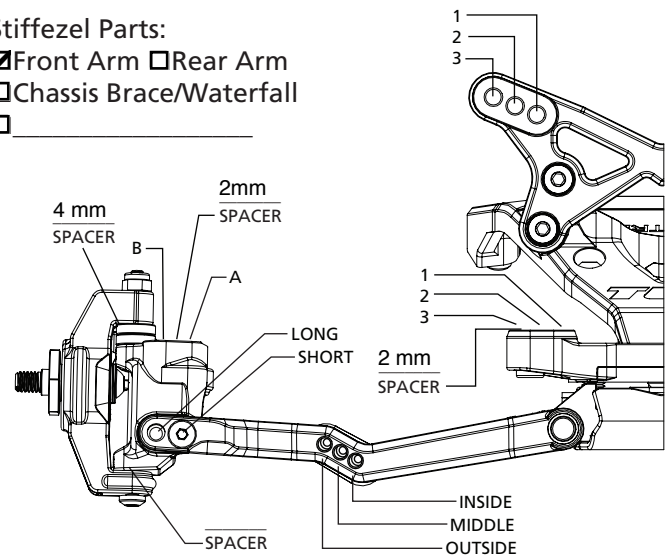

Notes: Brass Kick shim #TLR1049

**Rear Suspension**

Configuration:  Laydown  Standup  
 Diff. Height:  0  +1  +1.75  + 2.5  +3.5  
 Axle Height:  0  +3   
 Toe Plate:  LRC  LRC -2°  HRC  HRC -2°  
 Toe Inserts:  2.5  3.0  3.5  4.0 Arrow:  In  Out  
 Anti-Squat Inserts:  0  0.5  1  1.5  2  2.5  3  
 Ride Height: 20 mm Camber: -1.5°  
 Hub Spacing: 2mm Fr 2mm Rr Hex Width: std  
 Piston: 2x1.9mm Oil: 37.5 wt  
 Spring: LF Pink TLR233058 Sway Bar: none  
 Limiters: Internal: 0 External: 0 Stroke: 32 mm  
 Shock Eyelet:  Std.  +2 Shock Location: 2 - Middle  
 Shock Mounting:  Front  Rear  
 Tower:  Stiffezel  Carbon  Carbon +2mm   
 Camber Block Spacer:  1mm ↓  0mm  1mm ↑  
 Camber Link, Inner:  1  2  3  
 Camber Link, Outer:  A  B  C  D  E  
 Battery Position:  1  2  3  4  5   
 Wing/Wickerbill: Stock, Line #2  
 Wing Angle:  0°  2°  4°  
 Diff Type:  Ball  Gear Setting: 1 rotation  
 Driveshaft Length:  CVA  Universal Length: stock 68mm  
 Direct Drive  Slipper Pads:  Torque (yel)  Drive (org)

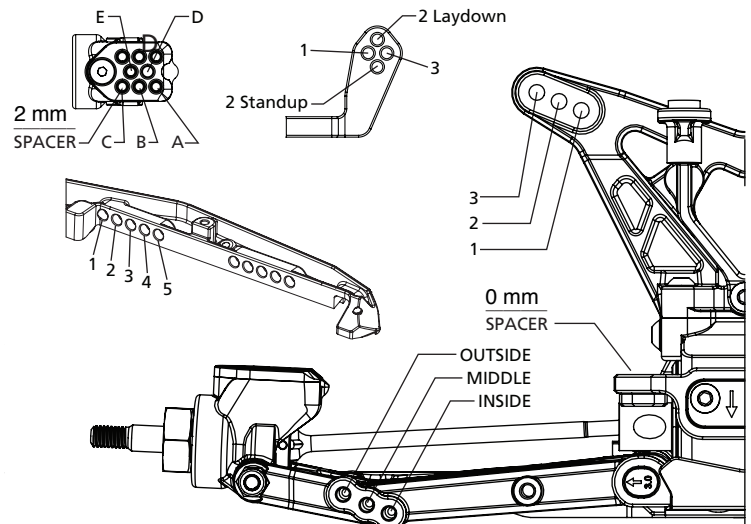

**Electronics**

Radio: Spektrum Timing Advance: 0  
 Servo: Highest DLP750 Steering Expo: Speed -10/-10  
 ESC: RC Concept SC10R Throttle/Brake EPA: 87/60  
 Initial Brake: Drag Motor: RC Concept 6.5T  
 Drag Brake: 2 Pinion: 21 Spur: 78  
 Throttle Profile: Line Battery: RC Concept Omega 4800  
 Battery Weight:

**Tires**

	Front	Rear
Thread:	JC Swaggers	Handout
Compound:		
Insert:		
Sauce:		

Notes: Wing raised 4mm

**Chassis**

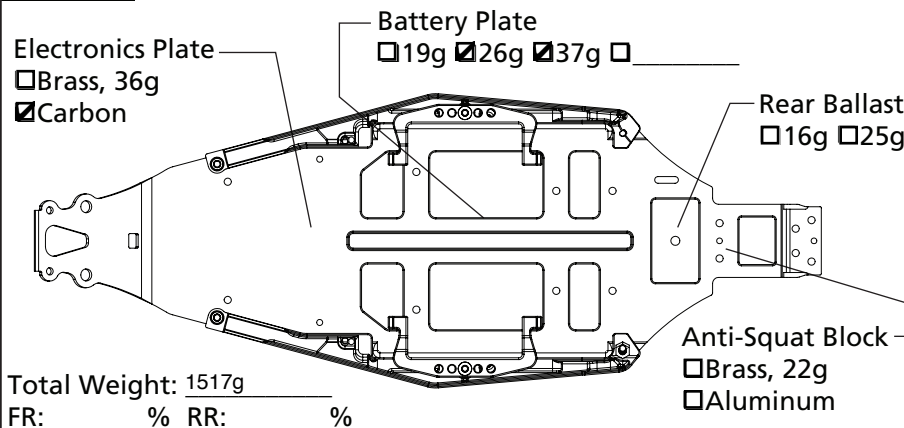

Total Weight: 1517g  
 FR: % RR: %